



150LM/W  
100W/150W/200W

# UFO HIGH BAY LIGHT

## Economical Type

✓ IP65

✓ 5 years warranty

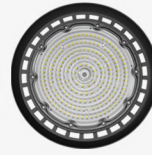

60°/90° PC Lens

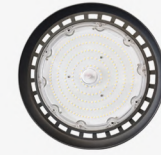

120° PC Lens



Heat Sink



### Description

- Die-casting aluminium technology, unique heat sink design, beautiful appearance.
- Light weight, compact structure, easy installation.
- Wide angle and wide range of illumination.
- High efficiency 150lm/w and Ra>80.
- Light does not contain ultraviolet and infrared rays, no light radiation.
- Input voltage AC108-305V.



### Application

- Warehouse
- Gymnasium
- Large supermarket
- Exhibition hall
- Gas station
- School auditorium
- Highway toll station
- Applicable to workshop
- Railway station waiting room and other lighting places

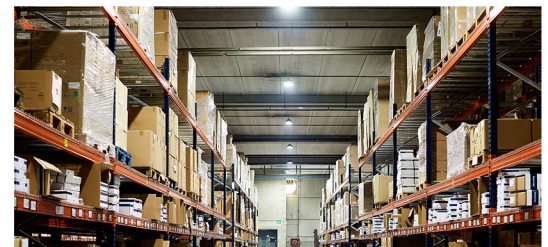
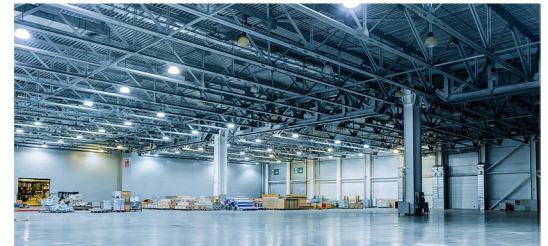

### Instruction

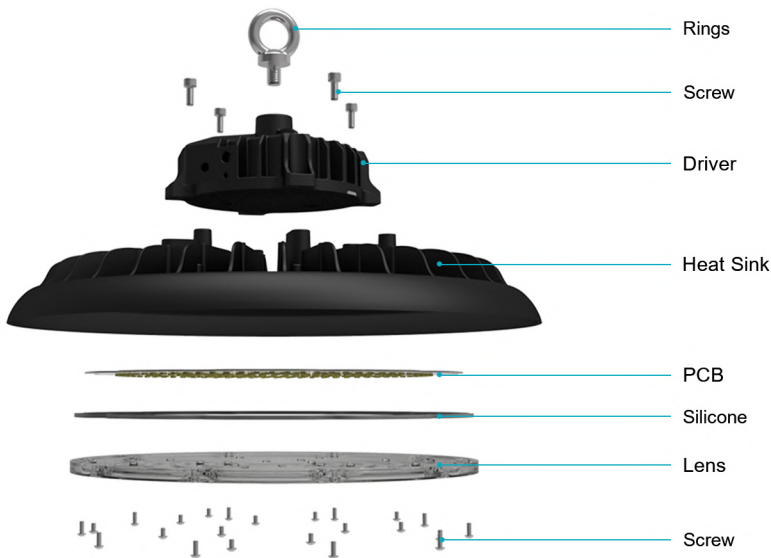

### Dimensions

Unit: mm

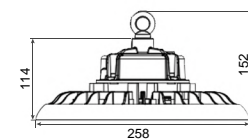

100LM/W

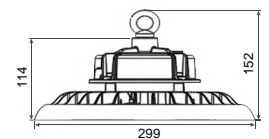

150LM/W

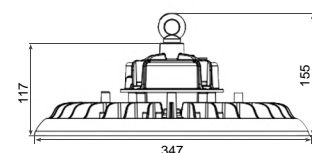

200LM/W

### Photoelectric

Model Number	GLM-MXHB100(F)	GLM-MXHB150(F)	GLM-MXHB200(F)
Power	100W	150W	200W
Dimensions	258*152mm	299*152mm	347*155mm
Beam Angle	60°/90° 120°	60°/90° 120°	120°
Luminous Efficiency	150 LM/W	150 LM/W	150 LM/W
Lumens Output	15000LM	22500LM	30000LM
Ra	80	80	80

\*Specifications using 5700K and subject to change. All parameters +/-10%.  
\*The total lumen for UGR products will be lower 8% than normal products.  
\*Available 3W on a per project basis.

# UFO High Bay Light ( Economical Type )

## Electrical Driver

Input	Brand SOSEN AC108-305V
Output	DC180-260V
Frequency	50/60Hz
Relevant	EN55015   EN550221   IEC61347-1
Power Factor	>0.95
THD	<20%
Power Efficiency	>90%
Protection	Surge   Short Circuit   Over Voltage   Over Current   Over Temp
MTBF	Minimum MTBF 50,000 hours at 100% load & 40 C



## Light Source

LED Type	Philips 3030
Color Accuracy(CRI)	80
Color Temperature	3000K/4000K/5000K/5700K

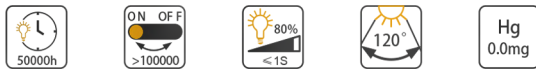

## About Reflector

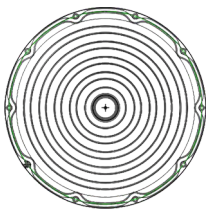

60°/90° PC Reflector

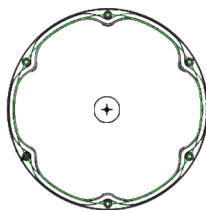

120° PC Reflector

## Packing List

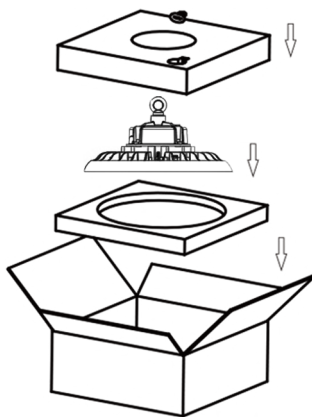

Item No	GLM-MXHB100(F)	GLM-MXHB150(F)	GLM-MXHB200(F)	Unit
CTN Size(L*W*H)	310*310*120	330*330*140	380*380*160	mm
N.W/PCS	2.25	3.1	3.65	KG
G.W/CTN	2.83	3.85	4.55	KG
Q'ty/CTN	1	1	1	PCS

## Environment

Operating Temperature	-20°C~ +40°C
Storage Temperature	-30°C~ +55°C
Operating Humidity	95% Rh or below(@-20°C~45°C)
Installation Height	20-50 Feet
Application Area	Indoors Or Outdoors
Lifespan	50,000 Hrs ( L80/B10 )

## Installation

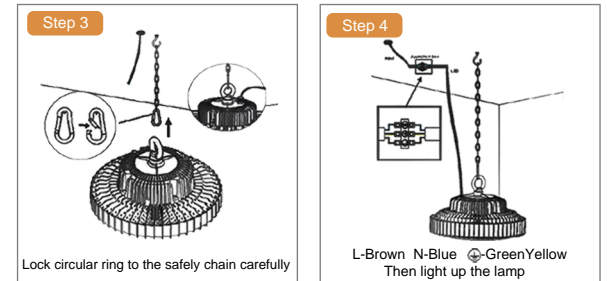
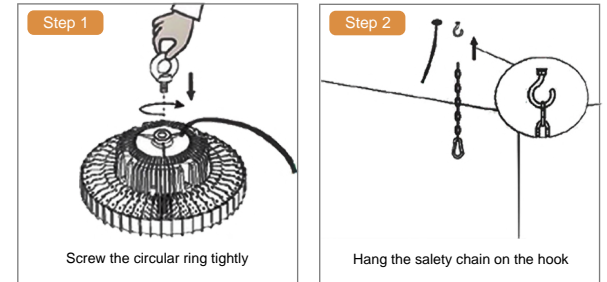

**Note:**  
AC 108-305V  
Cable

L Brown  
N Blue  
Green / Yellow

**Warning**

- Please make sure the power off before operation

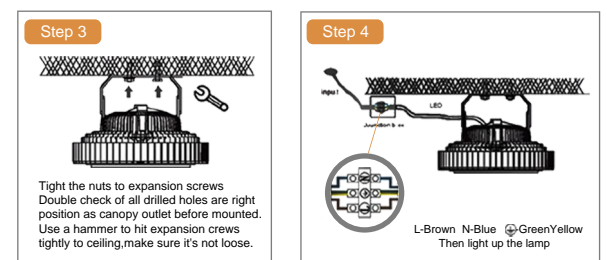
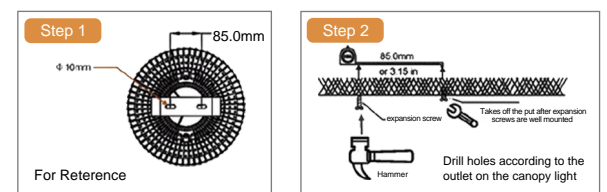

**Note:**  
AC 108-305V  
Cable

L Brown  
N Blue  
Green / Yellow

**Warning**

- Please make sure the power off before operation